

TYPICAL ROAD SECTION
N.T.S.

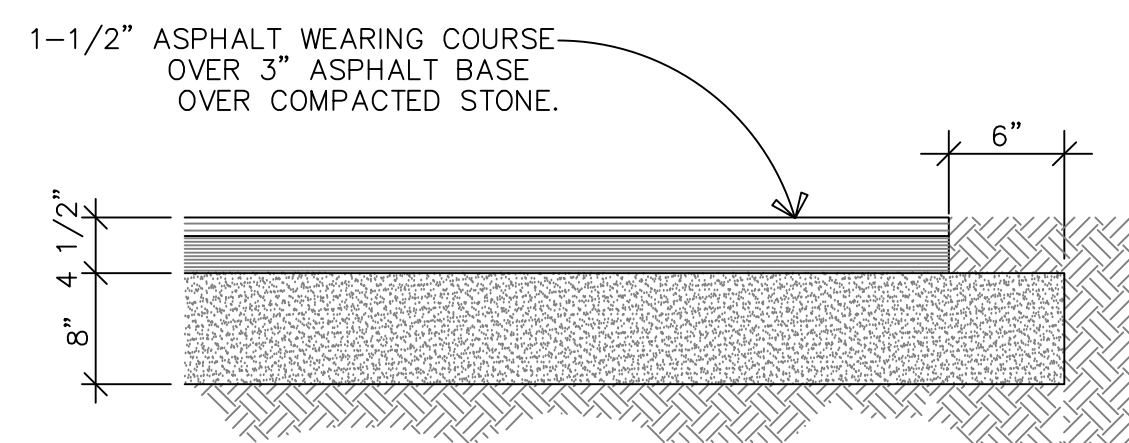

HEAVY DUTY PAVING
N.T.S.

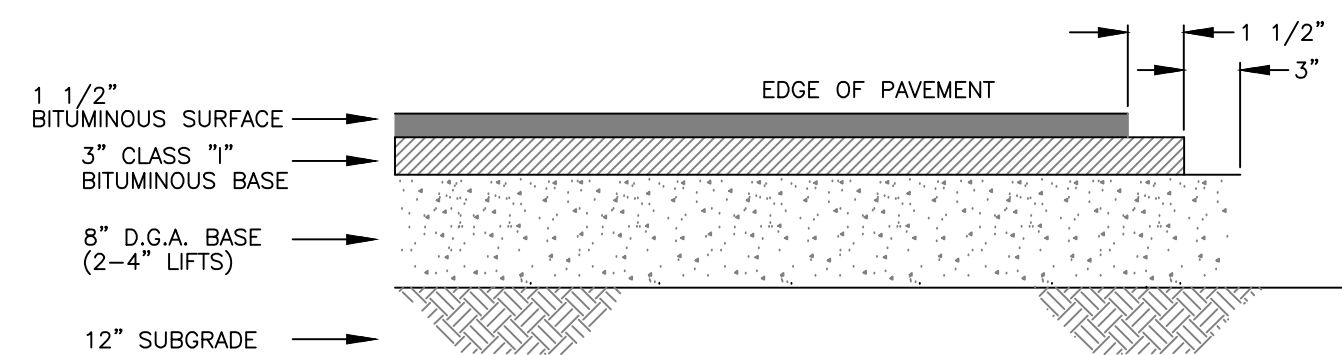

EDGE OF PAVEMENT HEAVY DUTY
N.T.S.

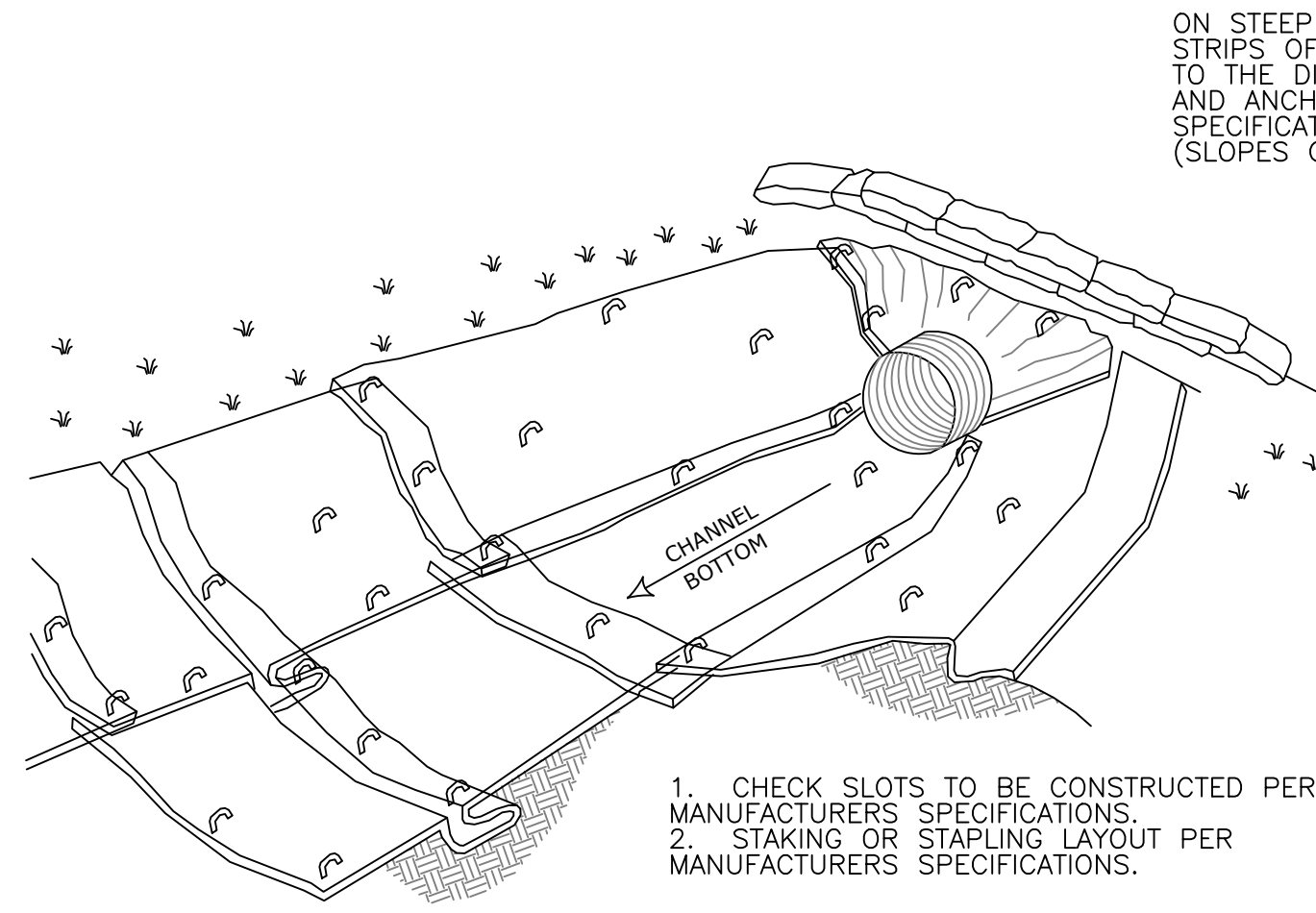

1. CHECK SLOTS TO BE CONSTRUCTED PER MANUFACTURER'S SPECIFICATIONS.
2. STAKING OR STAPLING LAYOUT PER MANUFACTURER'S SPECIFICATIONS.

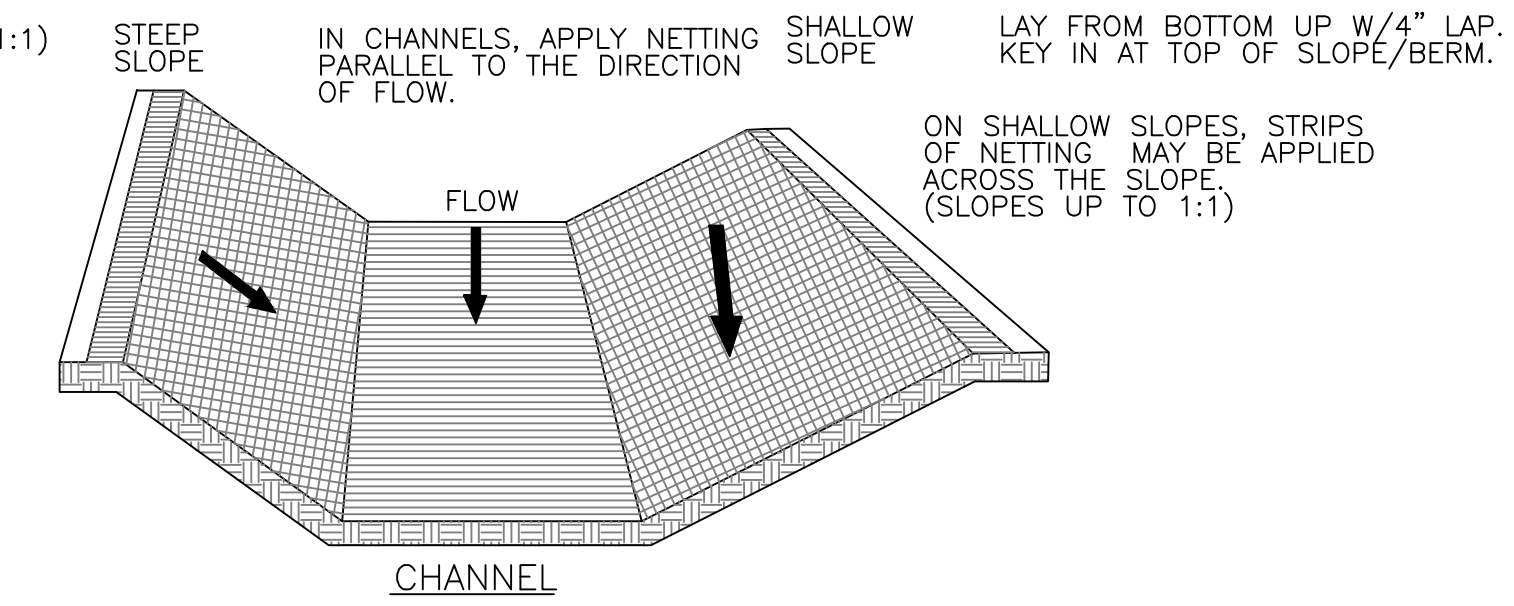

WHERE THERE IS A BERM AT THE TOP OF THE SLOPE, BRING THE NETTING OVER THE BERM AND ANCHOR IT BEHIND THE BERM.

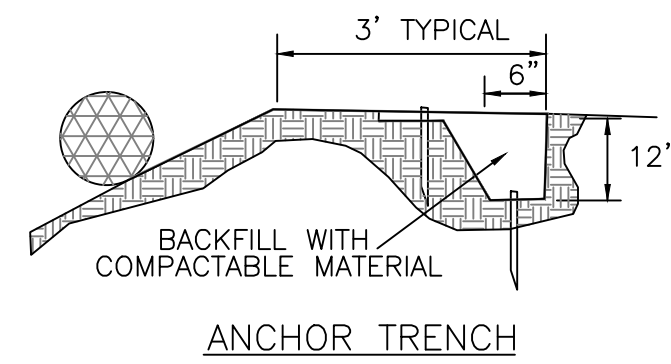
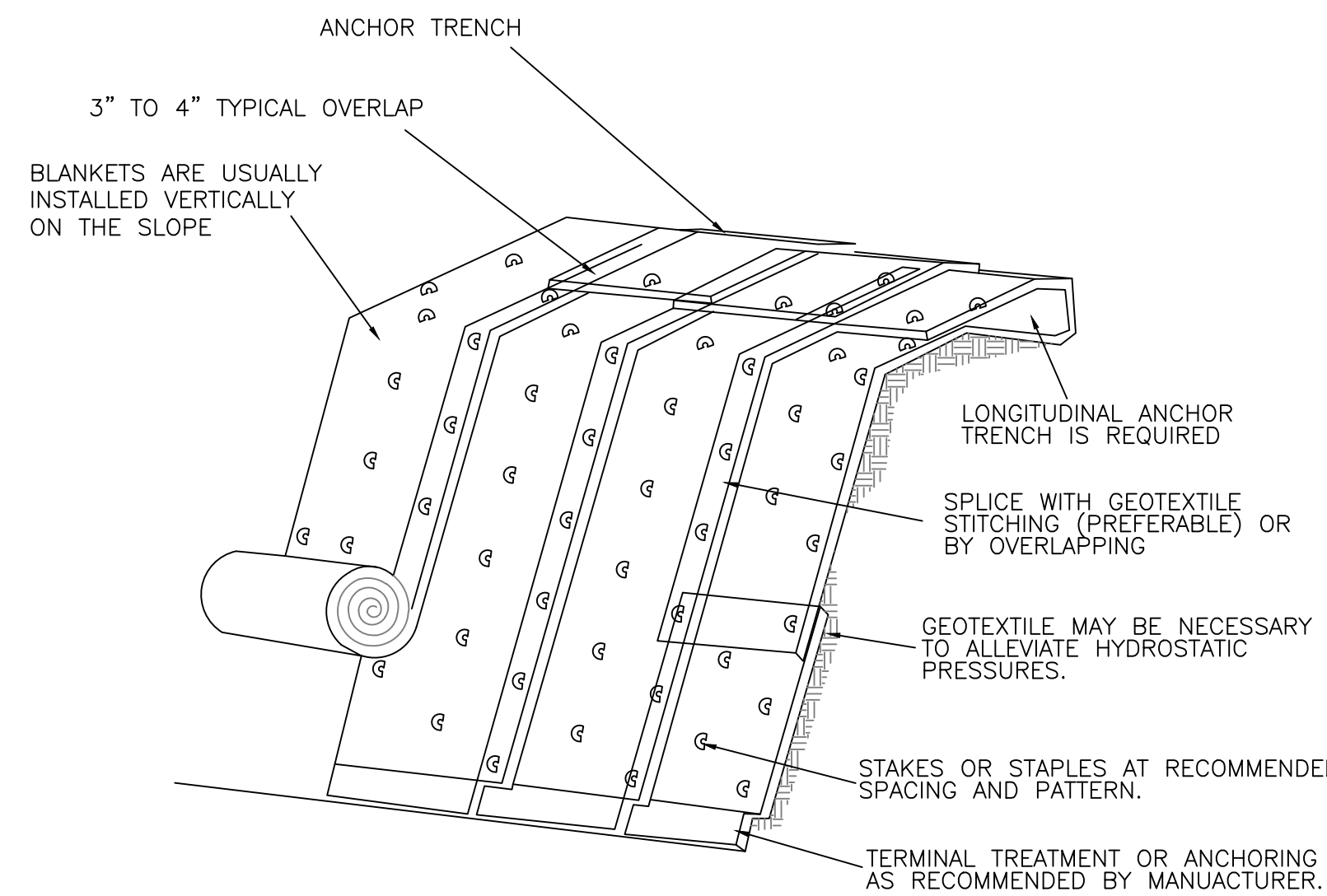
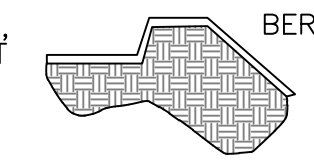

ANCHOR TRENCH

- NOTES:
1. STITCHING BLANKET SEAMS IS PREFERABLE TO OVERLAPPING BLANKET SEAMS.
 2. STAKING OR STAPLING LAYOUT SHALL CONFORM TO MANUFACTURER'S RECOMMENDATIONS FOR SLOPE AND GRADE.

BRING NETTING DOWN TO LEVEL AREA BEFORE TERMINATING THE INSTALLATION.

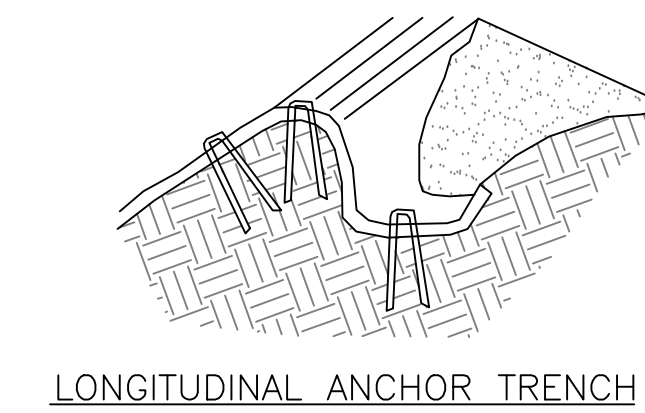

LONGITUDINAL ANCHOR TRENCH

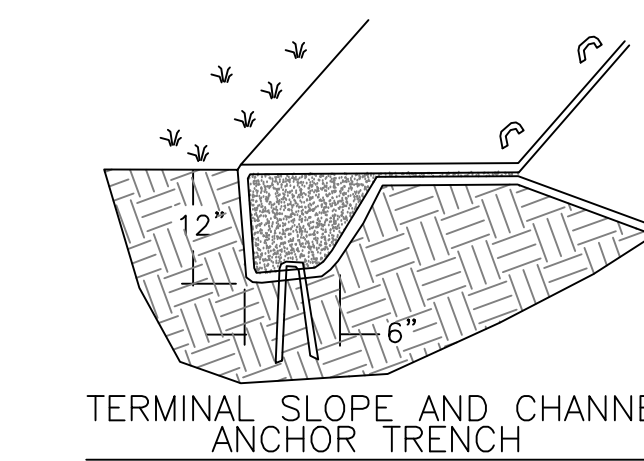

TERMINAL SLOPE AND CHANNEL ANCHOR TRENCH

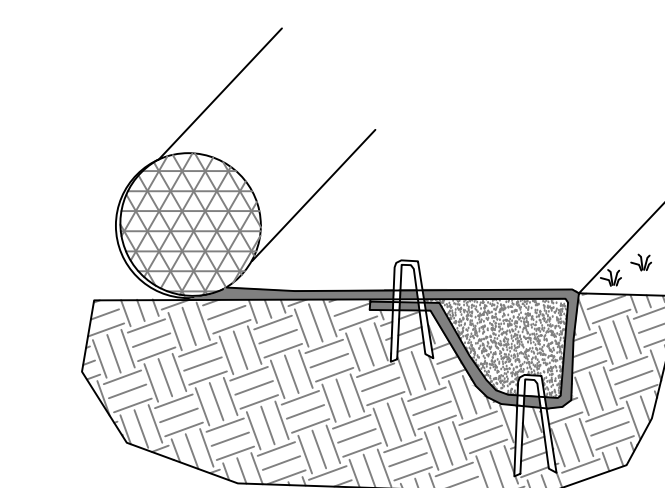

INITIAL CHANNEL ANCHOR TRENCH

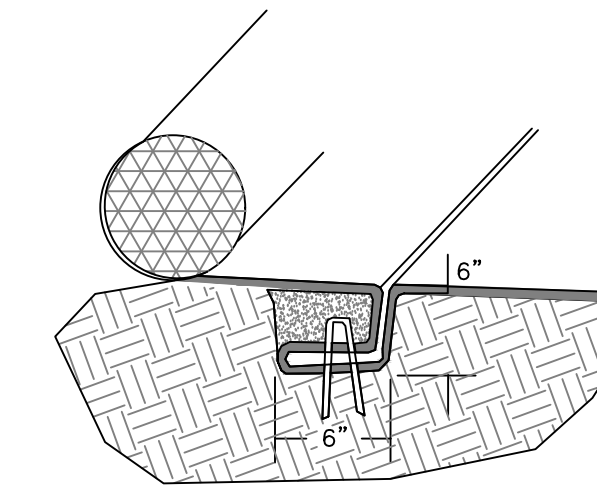

INTERMITTENT CHECK SLOT

EROSION CONTROL BLANKETS
N.T.S.

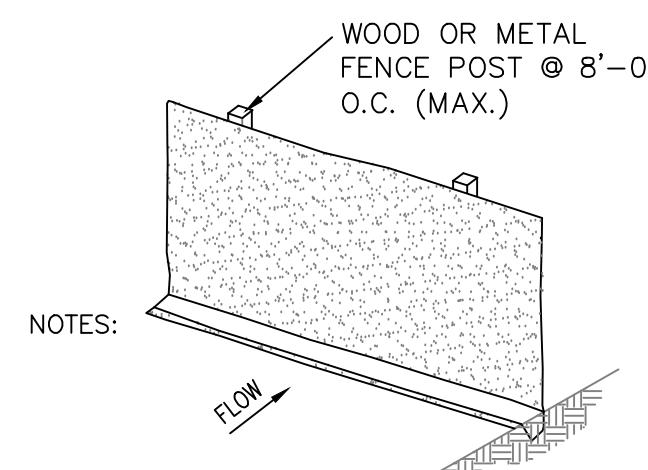

- NOTES:
1. FENCE POST SHALL BE AT LEAST 5 FEET LONG GEOTEXTILE FABRIC SHALL BE A MATERIAL RECOMMENDED FOR THIS USE BY THE MANUFACTURER.
 2. THE BOTTOM 12 INCHES OF THE FABRIC SHALL BE BURIED IN A 6 INCH TRENCH CUT INTO THE GROUND TO PREVENT SEDIMENT ESCAPING UNDER THE FENCE. ALL EARTHWORK SHALL BE DONE ON THE UPSTREAM SIDE OF THE FENCE.
 3. THE SILT FENCE SHALL BE ERECTED BEFORE GRADING IS BEGUN. THE GEOTEXTILE FABRIC SHALL BE ATTACHED TO THE POST, ON THE UPSTREAM SIDE, USING STAPLES, HOG RINGS OR OTHER APPROVED METHOD.
 4. REMOVE SILT FENCE UPON ESTABLISHMENT OF PERMANENT GROUND COVER.

TEMPORARY SILT FENCE DETAIL
N.T.S.

DATE	REVISION

Drawn by: KMF
Checked by: BANF
Approved: BANF
Filename:

GREEN COUNTY FISCAL COURT
206 W. COURT ST.
GREENSBURG, KENTUCKY 42743

PROPOSED BRIDGE @ LITTLE BRUSH CREEK ON DOC WARD RD.
GREENSBURG, KY

131 North Public Square
Greensburg, KY 42743
P: 270.973.5213
www.pitmangreen.com

DATE: MAY 19, 2026
SHEET 7 of 7

DETAILS

C-5.0

